

Packaging type

Taping specifications (Unit : mm)

●VMT3, EMT5/6

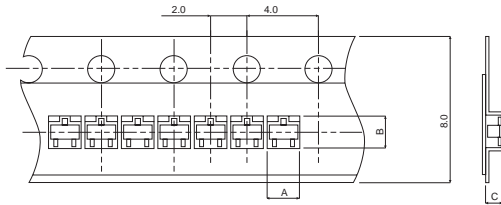

	A	B	C
VMN3	0.7	1.1	0.46
VMT3	1.65	1.3	0.65
EMT5/6	1.65	1.65	0.65
WEMT6	1.64	1.65	0.72

●EMT3, UMT3/5/6, TUMT3/5/6, SST3, SMT3/5/6, TSMT3/5/6

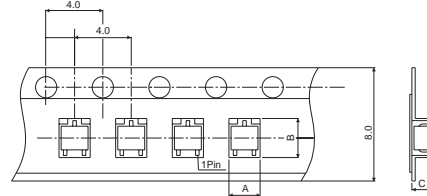

	A	B	C
EMT3	1.8	1.8	0.9
UMT3/5/6	2.2	2.4	1.15
TUMT3/5/6	2.2	2.4	0.98
SST3	3.1	2.7	1.2
TSST8	3.2	2.2	0.95
SMT3/5/6	3.1	3.2	1.35
TSMT3/5/6	3.1	3.2	1.1
TSMT8	3.2	3.1	0.95

●MPT3 / MPT6

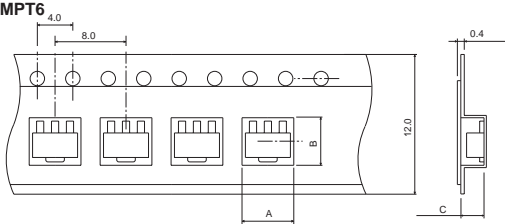

	A	B	C
MPT3	4.9	4.5	1.9
MPT6	4.9	4.4	1.3

●SOP8

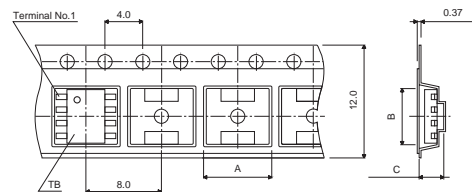

	A	B	C
SOP8	6.7	5.55	2.4

●CPT3 / TCPT3

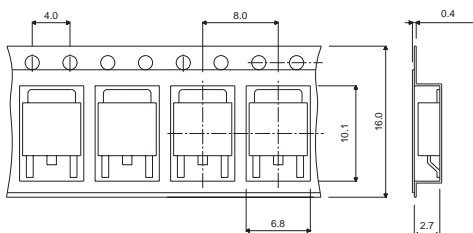

●LPTS

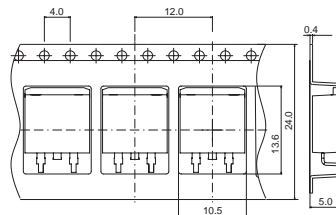

●SPT

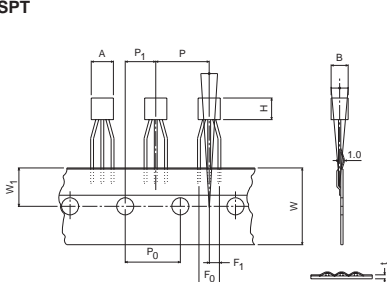

Code	SPT	TO92(Radial)
A	4.0	4.8
B	2.0	3.7
H	3.0	4.8
P	12.7	12.7
P ₀	12.7	12.7
P ₁	6.35	6.35
F ₀	5.0	5.0
F ₁	2.5	2.5
W	18.0	18.0
W ₁	9.0	9.0
t	0.7	0.7

●ATV

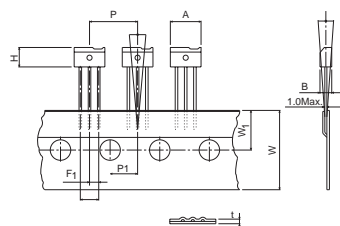

Code	ATV
A	6.8
B	2.5
H	4.4
P	12.7
P ₁	6.35
F ₀	5.08
F ₁	2.54
W	18.0
W ₁	9.0
t	0.7

Package	Code	Packaging style	Direction	Basic ordering unit (pcs)
VMN3	T2L	Embossed tape	One terminal on sprocket hole side	8000
VMT3	T2L	Embossed tape	One terminal on sprocket hole side	8000
EMT3F	TL	Embossed tape	One terminal on sprocket hole side	3000
EMT3	TL	Embossed tape	One terminal on sprocket hole side	3000
EMT5	T2R	Embossed tape	Three terminals on sprocket hole side	8000
EMT6	T2R	Embossed tape	Terminal No.1 on sprocket hole side	8000
WENT6	T2R	Embossed tape	Terminal No.1 on sprocket hole side	8000
UMT3F	TL	Embossed tape	One terminal on sprocket hole side	3000
UMT3	T106	Embossed tape	One terminal on sprocket hole side	3000
UMT5	TR	Embossed tape	Three terminals on sprocket hole side	3000
UMT6	TR	Embossed tape	Terminal No.1 on sprocket hole side	3000
	TN	Embossed tape	Non-direction	3000
TUMT3	TL	Embossed tape	One terminal on sprocket hole side	3000
TUMT5	TR	Embossed tape	Terminal No.1 on sprocket hole side	3000
TUMT6	TR	Embossed tape	Terminal No.1 on sprocket hole side	3000
SST3	T116	Embossed tape	One terminal on sprocket hole side	3000
TSST8	TR	Embossed tape	Terminal No.1 on sprocket hole side	3000
SMT3	T146	Embossed tape	One terminal on sprocket hole side	3000
SMT5	T148	Embossed tape	Three terminals on sprocket hole side	3000
SMT6	T108	Embossed tape	Terminal No.1 on opposite side from sprocket hole side	3000
	T110	Embossed tape	Non-direction	3000
TSMT3	TL	Embossed tape	One terminal on sprocket hole side	3000
TSMT5	TR	Embossed tape	Terminal No.1 on sprocket hole side	3000
TSMT6	TR	Embossed tape	Terminal No.1 on sprocket hole side	3000
TSMT8	TR	Embossed tape	Terminal No.1 on sprocket hole side	3000
TSMT8	TL	Embossed tape	The direction shall be one in a reel	3000
SOP8	TB	Embossed tape	Terminal No.1 on sprocket hole side	2500
MPT3	T100	Embossed tape	Three terminals on sprocket hole side	1000
MPT6	TR	Embossed tape	Terminal No.1 on sprocket hole side	1000
CPT3	TL	Embossed tape	Fin on sprocket hole side	2500
TCPT3	TL	Embossed tape	One terminal on sprocket hole side	2500
LPTS	TL	Embossed tape	Fin on sprocket hole side	1000
SPT	TP	Radial tape	Ammo Box	5000
TO-92	T93	Radial tape	Ammo Box	3000
ATV	TV2	Radial tape	Ammo Box	2500
TO-220FN	-	bulk	Box	500
TO-220FM	-	bulk	Box	500

Notes

No copying or reproduction of this document, in part or in whole, is permitted without the consent of ROHM Co.,Ltd.

The content specified herein is subject to change for improvement without notice.

The content specified herein is for the purpose of introducing ROHM's products (hereinafter "Products"). If you wish to use any such Product, please be sure to refer to the specifications, which can be obtained from ROHM upon request.

Examples of application circuits, circuit constants and any other information contained herein illustrate the standard usage and operations of the Products. The peripheral conditions must be taken into account when designing circuits for mass production.

Great care was taken in ensuring the accuracy of the information specified in this document. However, should you incur any damage arising from any inaccuracy or misprint of such information, ROHM shall bear no responsibility for such damage.

The technical information specified herein is intended only to show the typical functions of and examples of application circuits for the Products. ROHM does not grant you, explicitly or implicitly, any license to use or exercise intellectual property or other rights held by ROHM and other parties. ROHM shall bear no responsibility whatsoever for any dispute arising from the use of such technical information.

The Products specified in this document are intended to be used with general-use electronic equipment or devices (such as audio visual equipment, office-automation equipment, communication devices, electronic appliances and amusement devices).

The Products specified in this document are not designed to be radiation tolerant.

While ROHM always makes efforts to enhance the quality and reliability of its Products, a Product may fail or malfunction for a variety of reasons.

Please be sure to implement in your equipment using the Products safety measures to guard against the possibility of physical injury, fire or any other damage caused in the event of the failure of any Product, such as derating, redundancy, fire control and fail-safe designs. ROHM shall bear no responsibility whatsoever for your use of any Product outside of the prescribed scope or not in accordance with the instruction manual.

The Products are not designed or manufactured to be used with any equipment, device or system which requires an extremely high level of reliability the failure or malfunction of which may result in a direct threat to human life or create a risk of human injury (such as a medical instrument, transportation equipment, aerospace machinery, nuclear-reactor controller, fuel-controller or other safety device). ROHM shall bear no responsibility in any way for use of any of the Products for the above special purposes. If a Product is intended to be used for any such special purpose, please contact a ROHM sales representative before purchasing.

If you intend to export or ship overseas any Product or technology specified herein that may be controlled under the Foreign Exchange and the Foreign Trade Law, you will be required to obtain a license or permit under the Law.



Thank you for your accessing to ROHM product informations.
More detail product informations and catalogs are available, please contact us.

ROHM Customer Support System

<http://www.rohm.com/contact/>